



Holder Construction Company
Eppley Airfield Terminal Modernization Program
Project Information Session



WELCOME

Opening Comments

Project Information Session

Agenda

1. About Holder Construction Company
2. Project Overview
3. Project Website
4. Project Phasing
5. Project Schedule
6. Procurement / Trade Opportunities / SEB & DBE
7. Preliminary Bidding Schedule
8. Procurement Process
9. Prequalification Requirements
10. Project Contacts

About Holder Construction Company

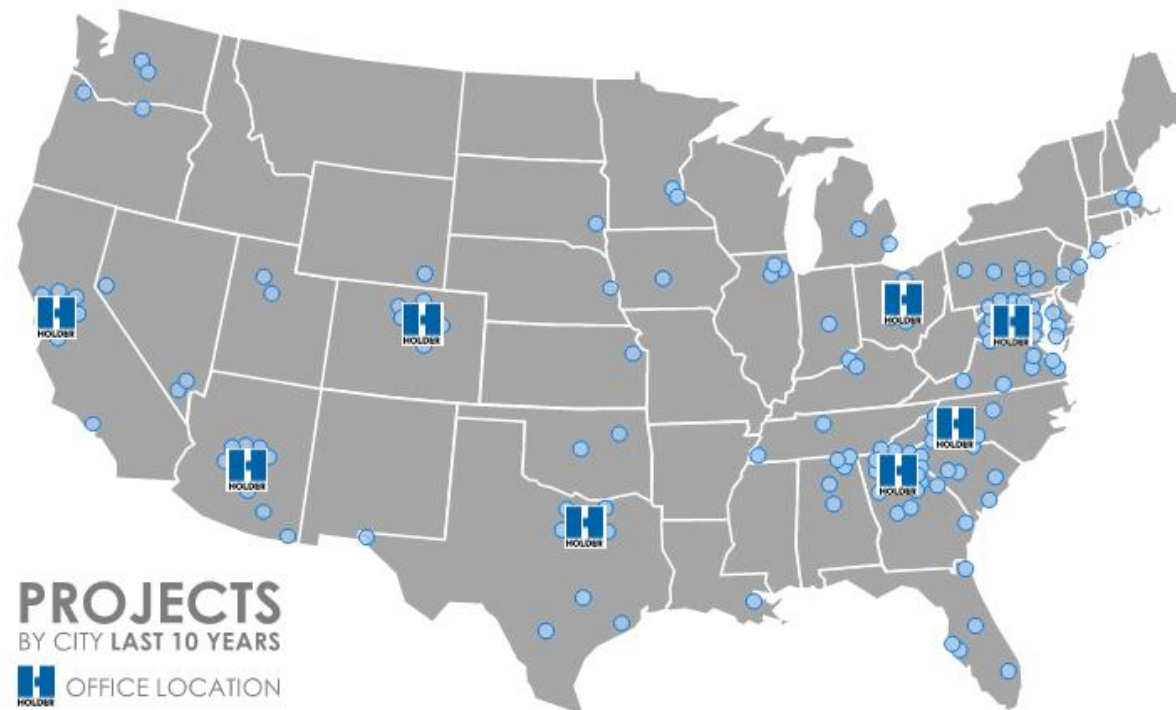

About Holder Construction Company

ABOUT HOLDER

The best teams trust Holder to deliver their most important work. Our people redefine the construction experience.
WE LEAD WITH INTEGRITY. WE SEEK EXCELLENCE. WE CARE MORE.

Founded on Trust

Since 1960, we've built a reputation for excellence. We value relationships established on a promise and cultivated with trust. Our most valuable resources are our people who carry forth our traditions, values, and long-standing reputation for performance. Though we span seven offices and projects in more than 30 states, we strive to operate as "one company." This means our teams work together across regions and markets to deliver a high quality, consistent result to our clients no matter where we serve them. We have consistently ranked at the top of ENR's Top 400 Contractor's list, and for the last 15 years listed in the nation's largest data center builders.



Supporting our Clients

Holder's reputation for delivering the highest level of service and collaborating with clients and partners parallels our founding principle: "Do the kind of job that makes our clients want us to do their next project." The result, more than 90% of our work is from repeat clients. The strength of our relationships, our dedicated associates, and operating as "one company" has allowed us to build on a national level and support our clients wherever they have a need.

Serving Our Communities

More than a builder, we are a company of individuals with strong connections to each other and our communities. We value community service and our associates give their time to hundreds of causes. Our teams across the US volunteer together on service projects, donation collections, and awareness campaigns. Our primary impact cause is improving the opportunity and quality of life for the construction workforce. We support local workforce development initiatives, scholarships, and construction management programs across the US. Together with our industry partners we are creating opportunity - bringing together skilled training, advanced education, job opportunities, and access to a better living wage.



\$10B in Aviation

61 Projects

About Holder Construction Company

Recent Aviation Portfolio

- ✓ Atlanta (ATL) International Terminal
- ✓ Atlanta (ATL) Concourse C Midpoint Expansion
- ✓ Atlanta (ATL) Concourse D Midpoint Expansion
- ✓ Atlanta (ATL) West Deck
- ✓ Atlanta (ATL) Concourse D Widening
- ✓ Atlanta (ATL) South Deck
- ✓ Salt Lake City (SLC) Terminal Redevelopment Program
- ✓ Charlotte (CLT) Terminal Lobby Expansion and Central Utility Plant
- ✓ Denver (DEN) Concourse C Expansion
- ✓ Denver (DEN) Concourse B Expansion
- ✓ DFW Operations Center
- ✓ Nashville (BNA) Satellite Concourse
- ✓ Eppley Airfield Terminal Modernization Program
- ✓ Burbank Terminal Replacement Program

Project Overview



Progressive Design-Build Agreement



Project Overview

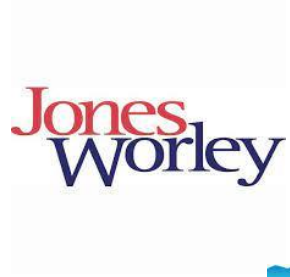

AIRPROJECTS



walter
p moore



Project Overview



Project Overview

- Consolidated Security Checkpoint
- Enhanced Concessions / Retail
- Renovations
- Additional Hold Room space
- 3 Additional Gates
- International Arrivals / Sterile Corridor
- Enhanced Vertical Circulation

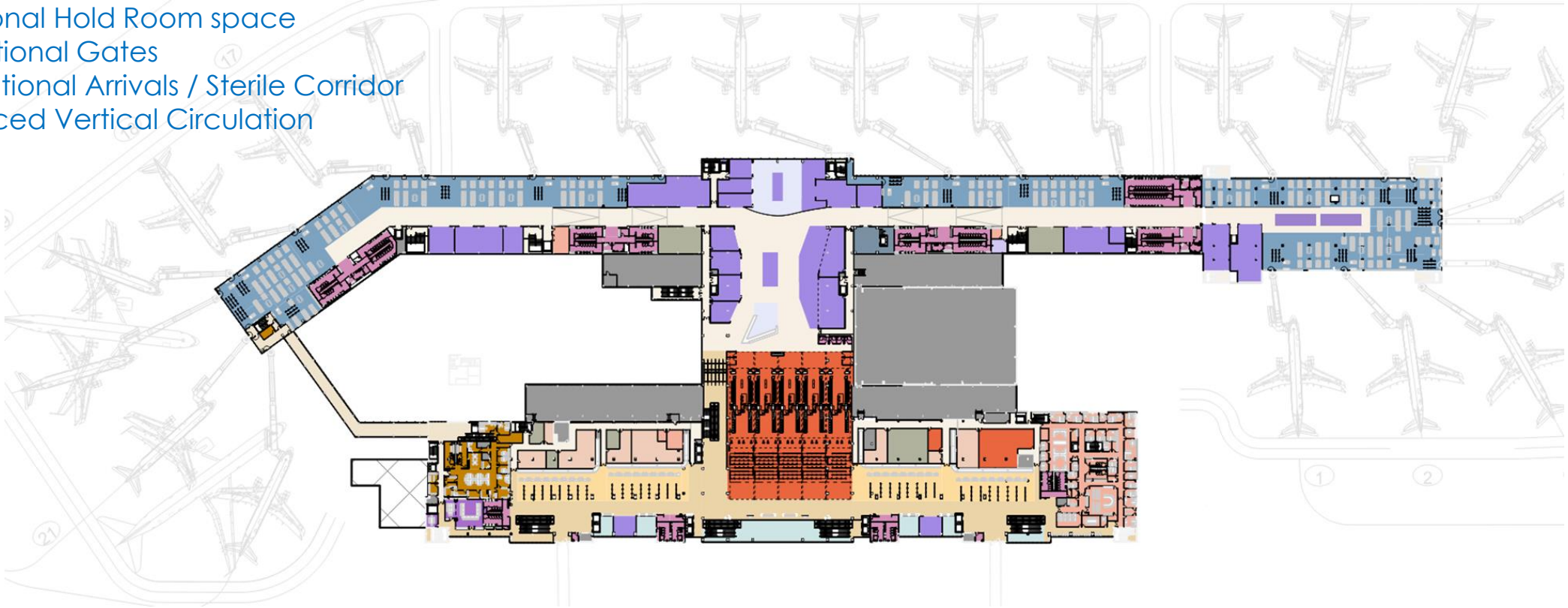

Level 2

Project Overview

- Consolidated/Centralized Baggage System
- International Arrivals / CBP
- Bag Claim to meet Passenger Activity Levels
- Renovations



Level 1

Project Website

- **www.holder-oma.com**
 - Real-time updates
 - Access to Prequalification
 - Bid Opportunities
 - Holder Contact Information



EPPLEY AIRFIELD TERMINAL MODERNIZATION PROGRAM

[Home](#) | [About Us](#) | [Project Updates](#) | [Outreach](#) | [Prequalification](#) | [SEB/DBE Program](#) | [Bid Opportunities](#) | [Contact Us](#) | [Link to FlyOMA.com](#)

WELCOME TO HOLDER CONSTRUCTION COMPANY'S
PROJECT WEBSITE FOR THE EPPLEY AIRFIELD
TERMINAL MODERNIZATION PROGRAM



Project Phasing

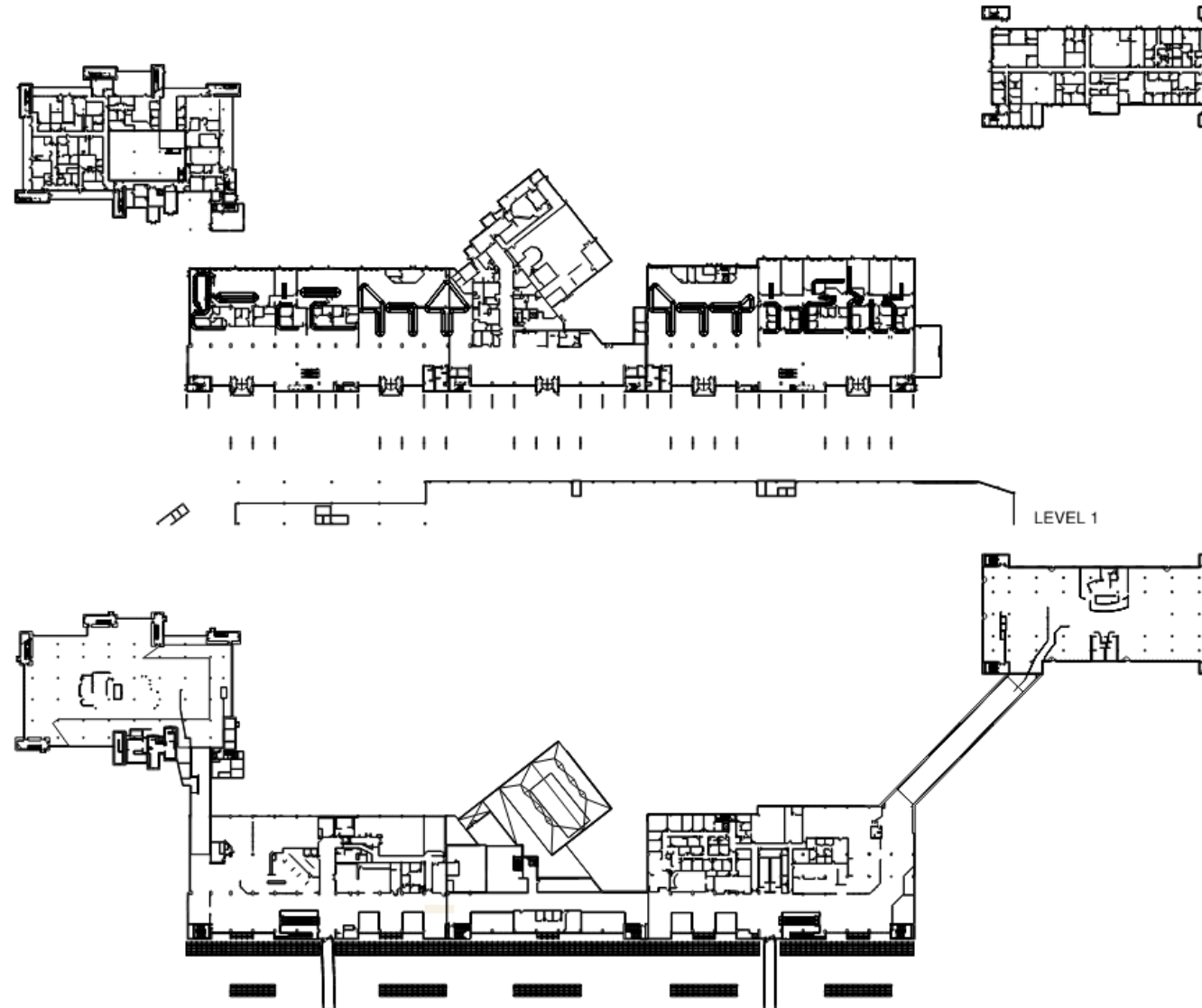

Existing

Project Phasing

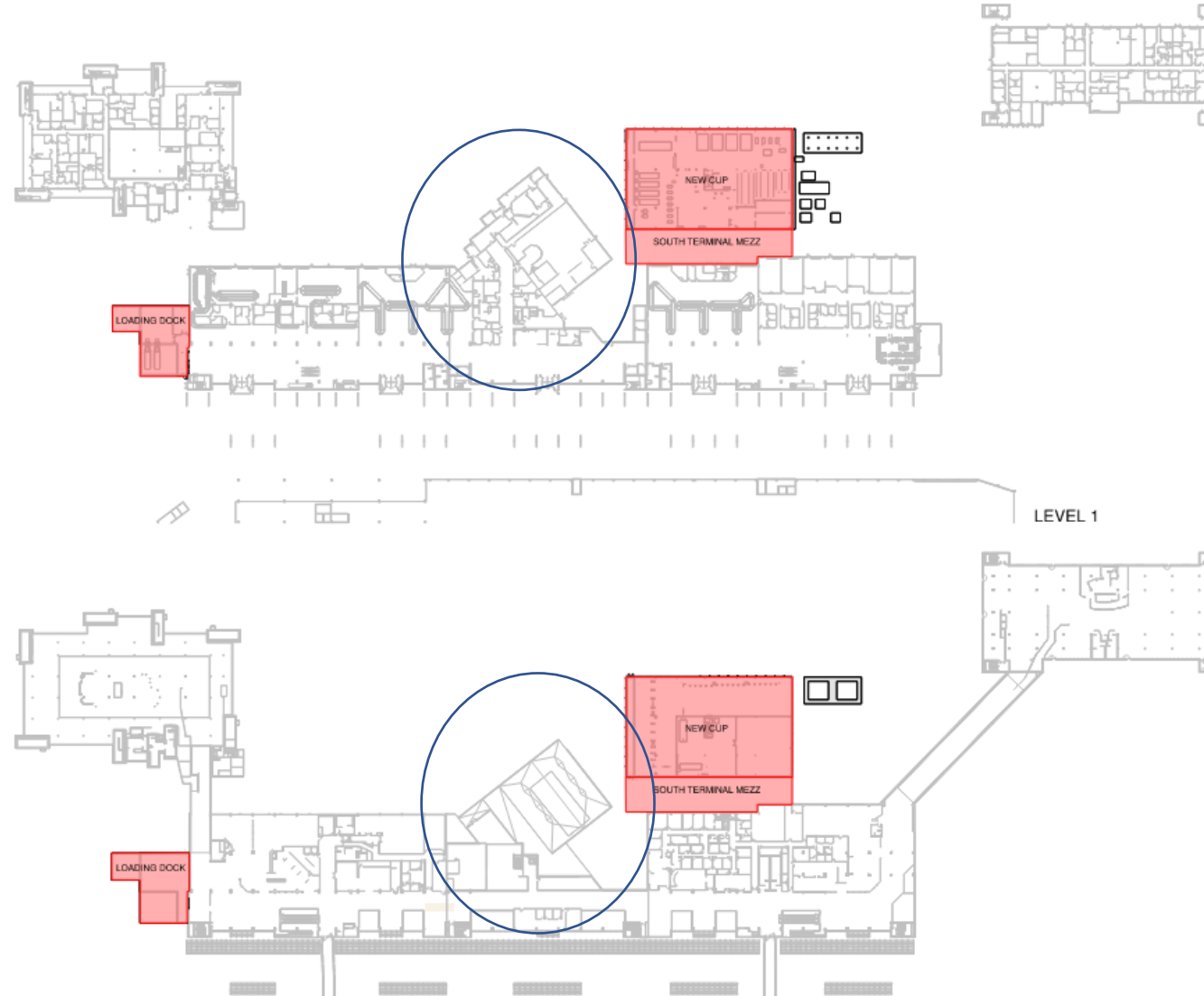

Phase 1

Project Phasing

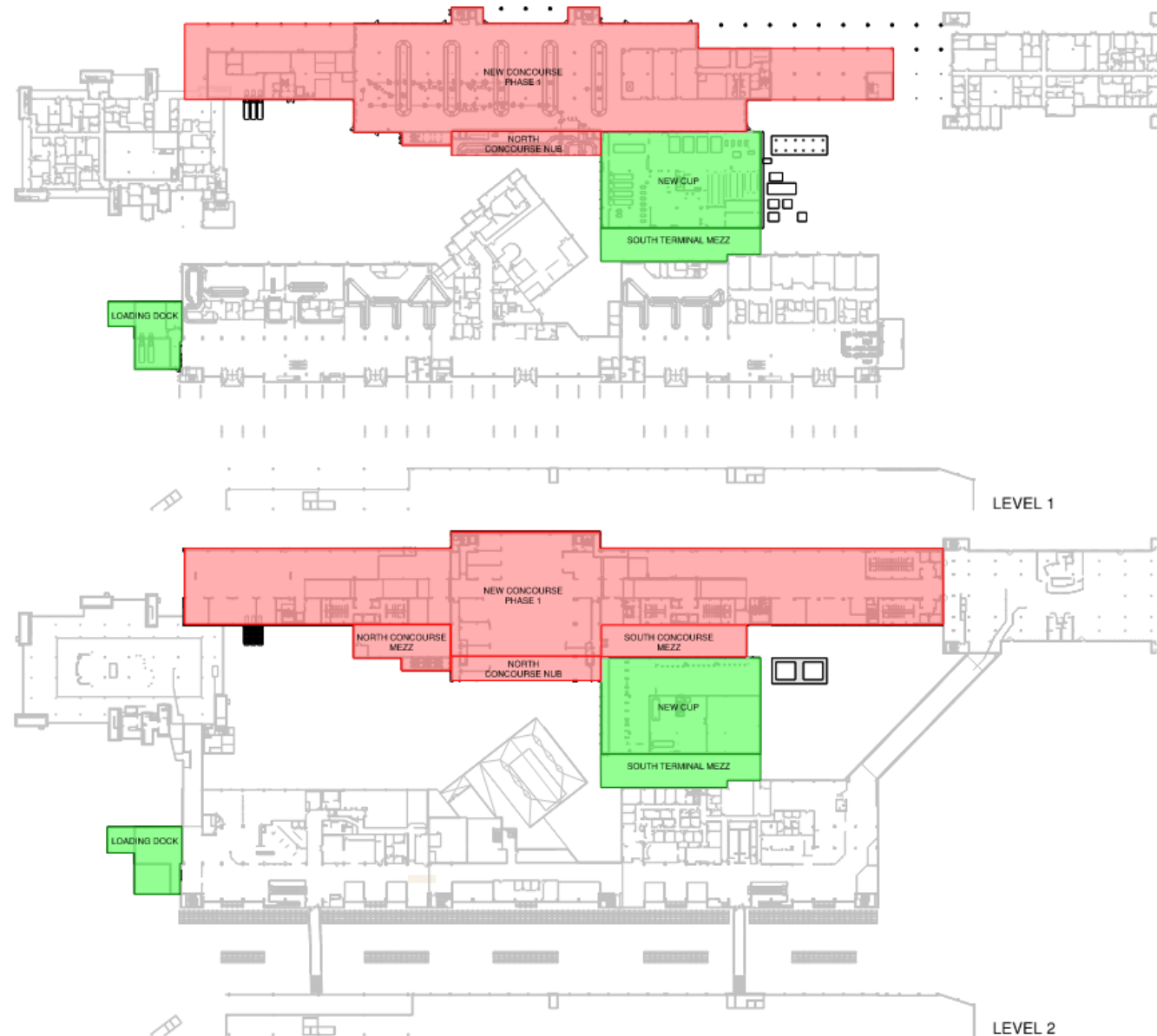

Phase 2

Project Phasing

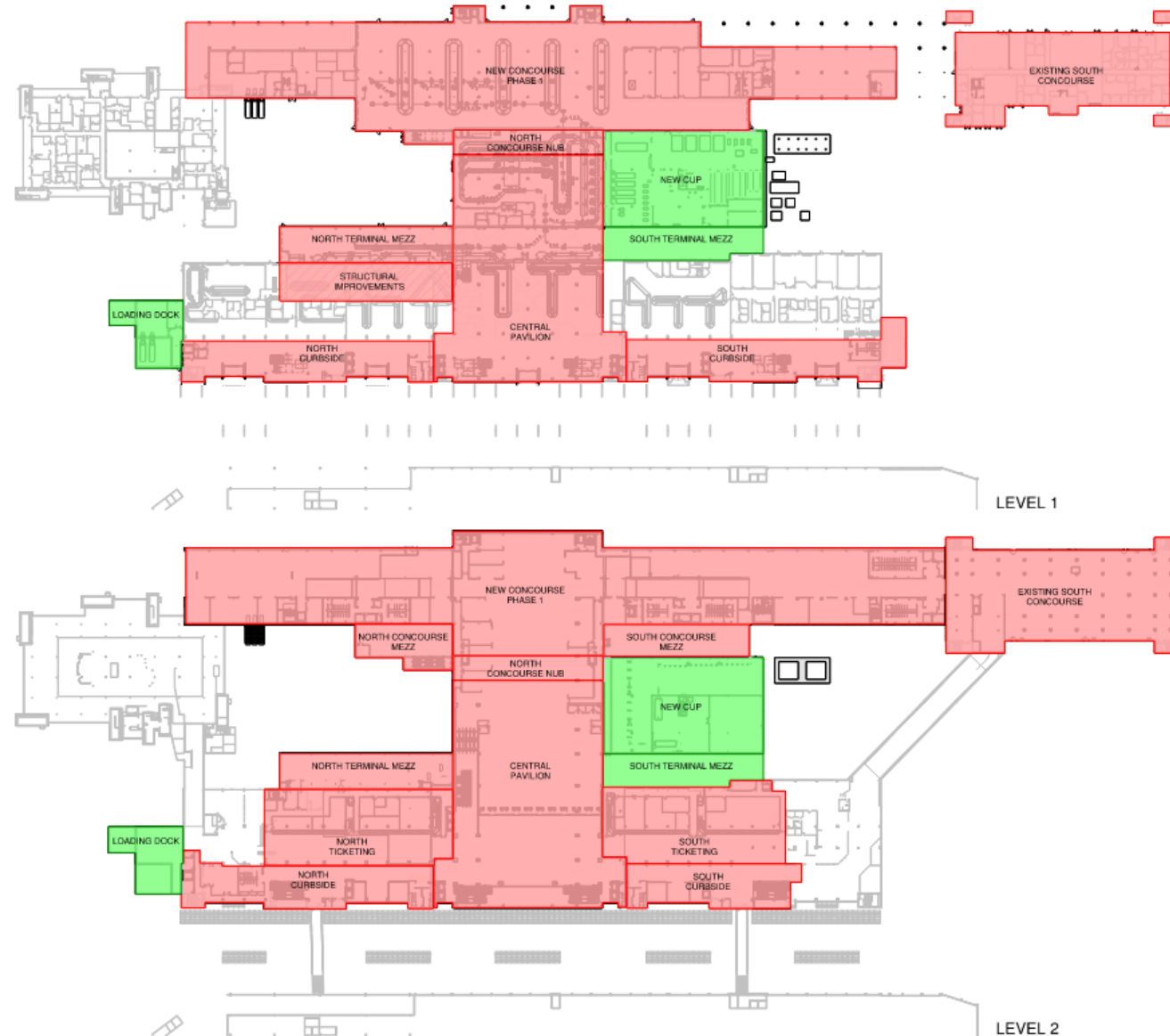

Phase 3

Project Phasing

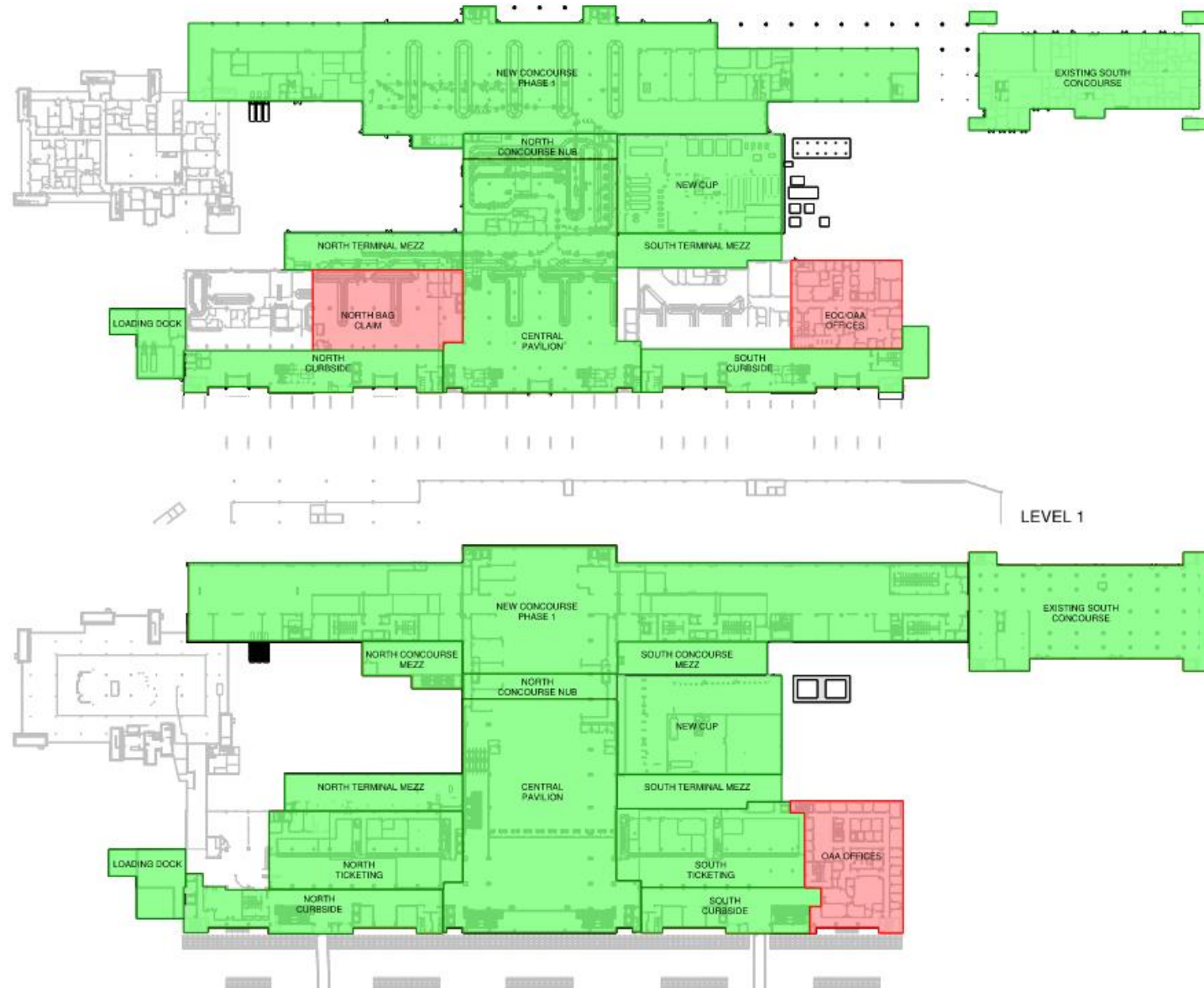

Phase 4

Project Phasing

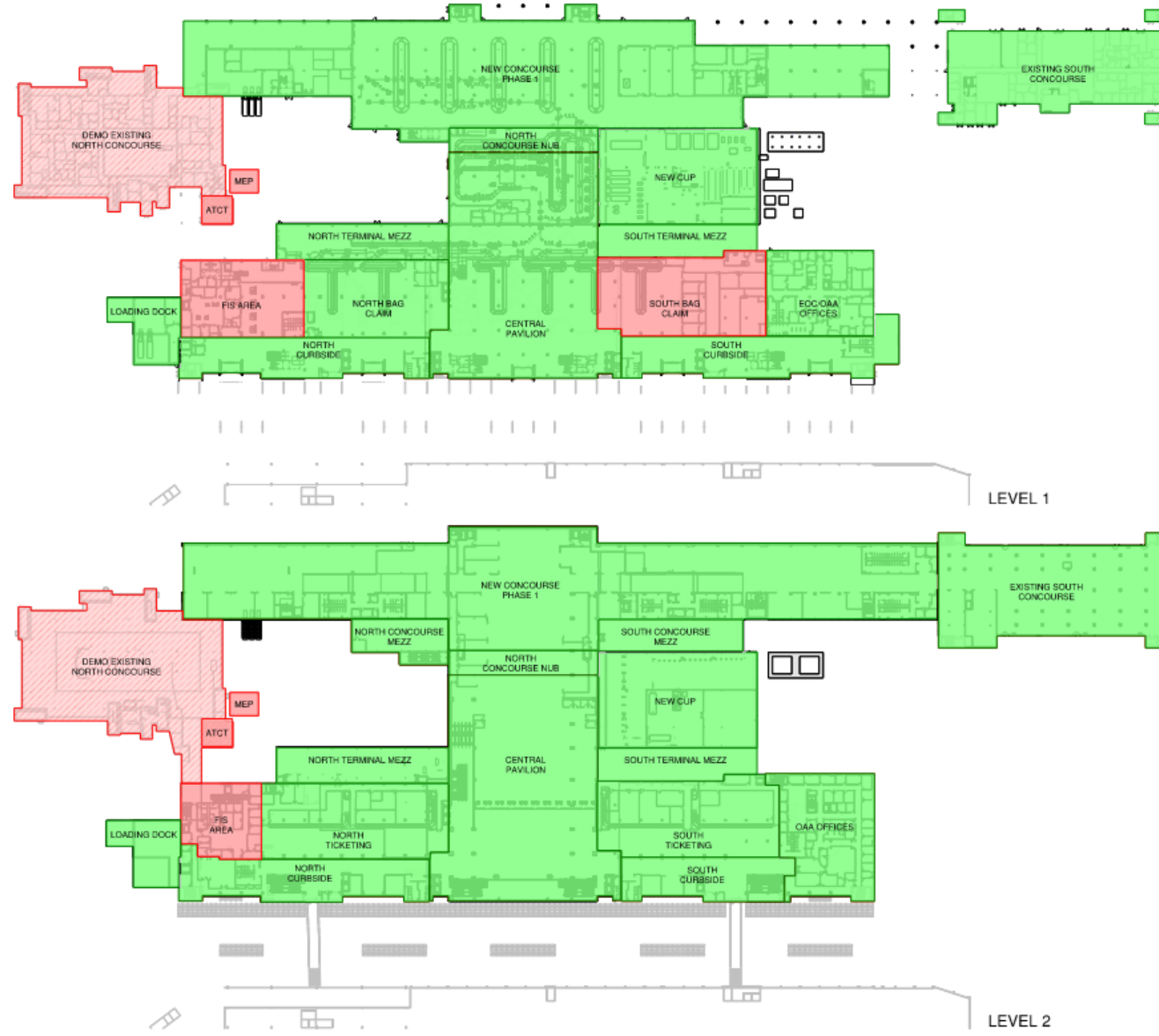

Phase 5

Project Phasing

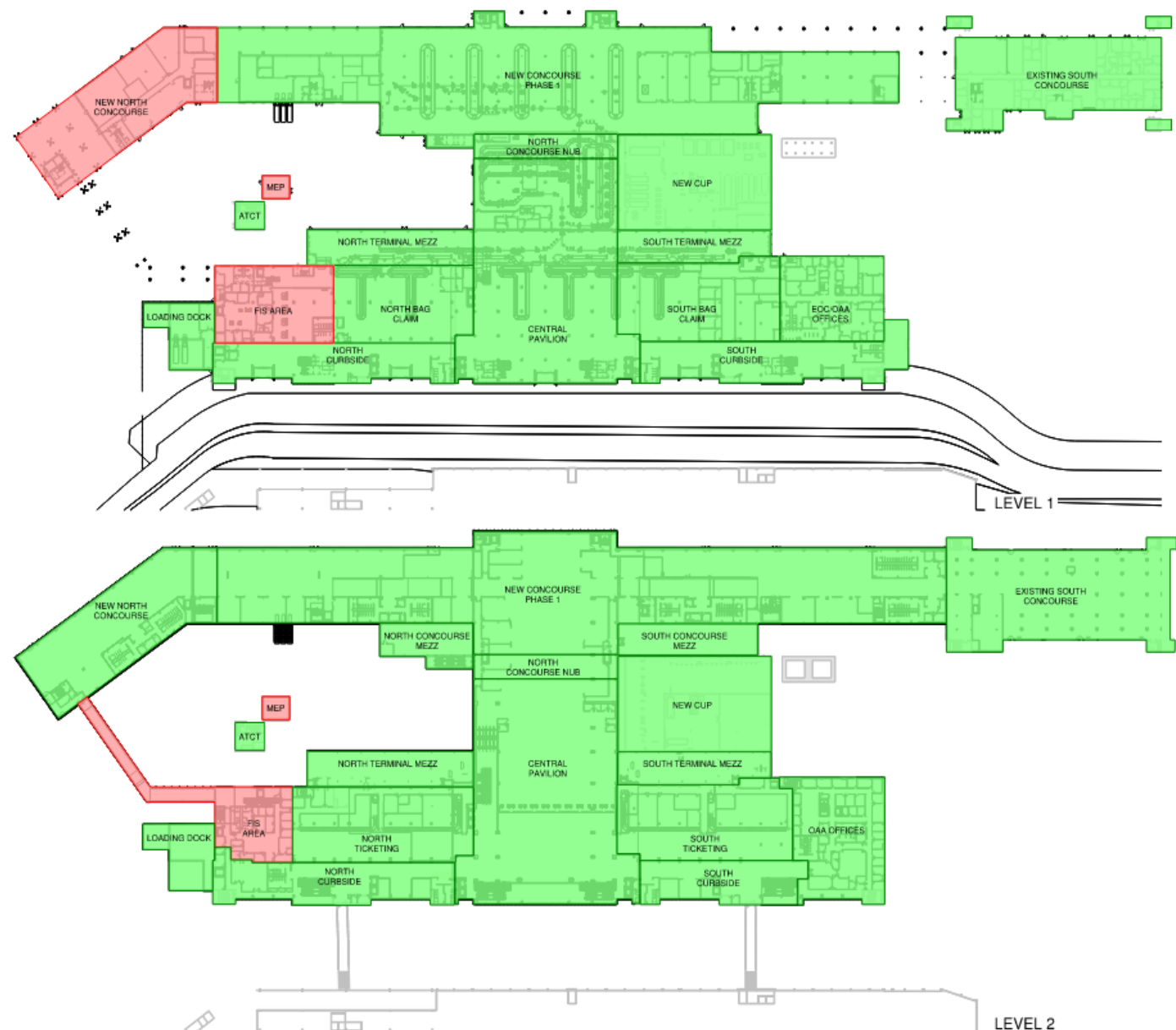

Phase 6

Project Phasing

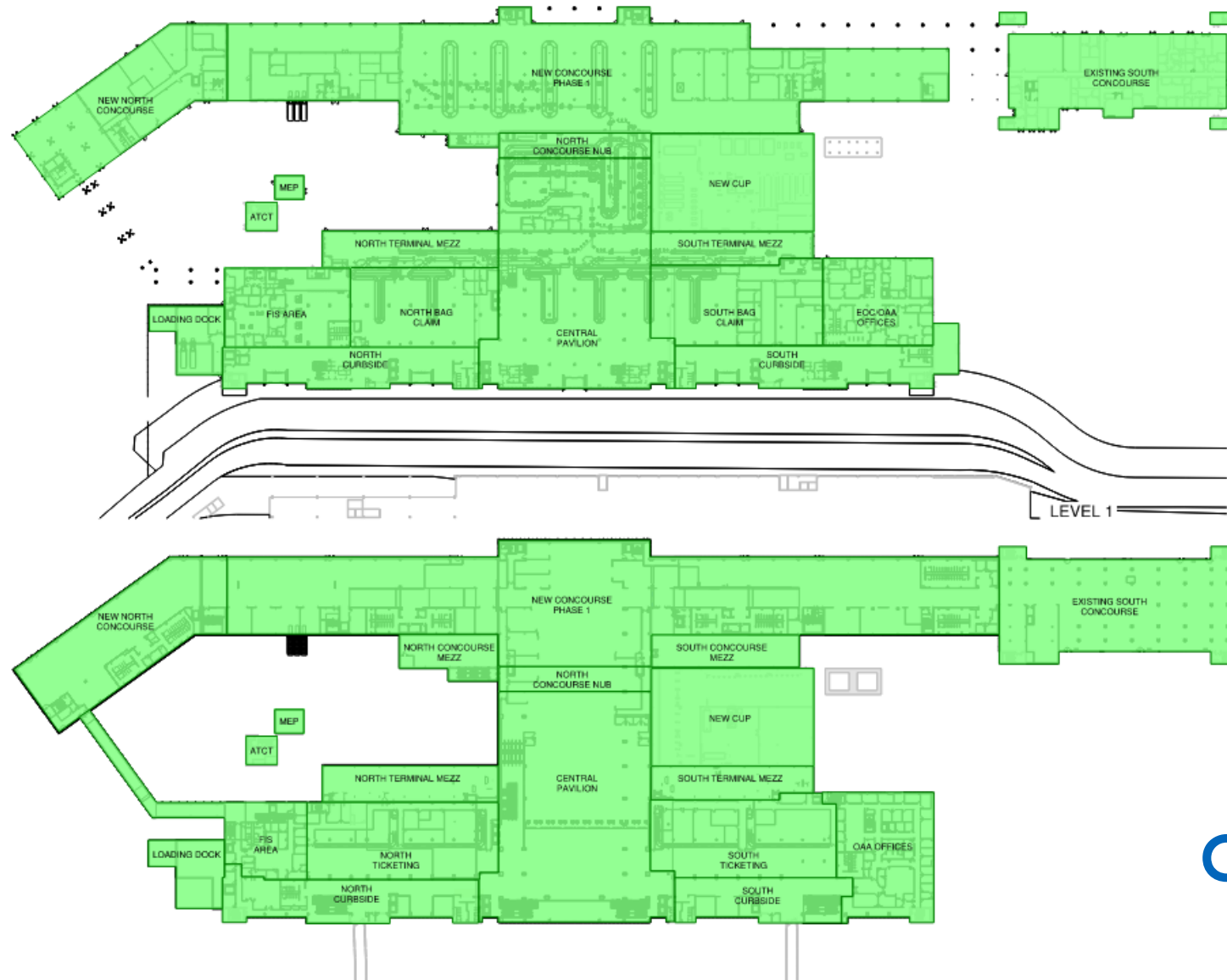

Completion

Project Schedule

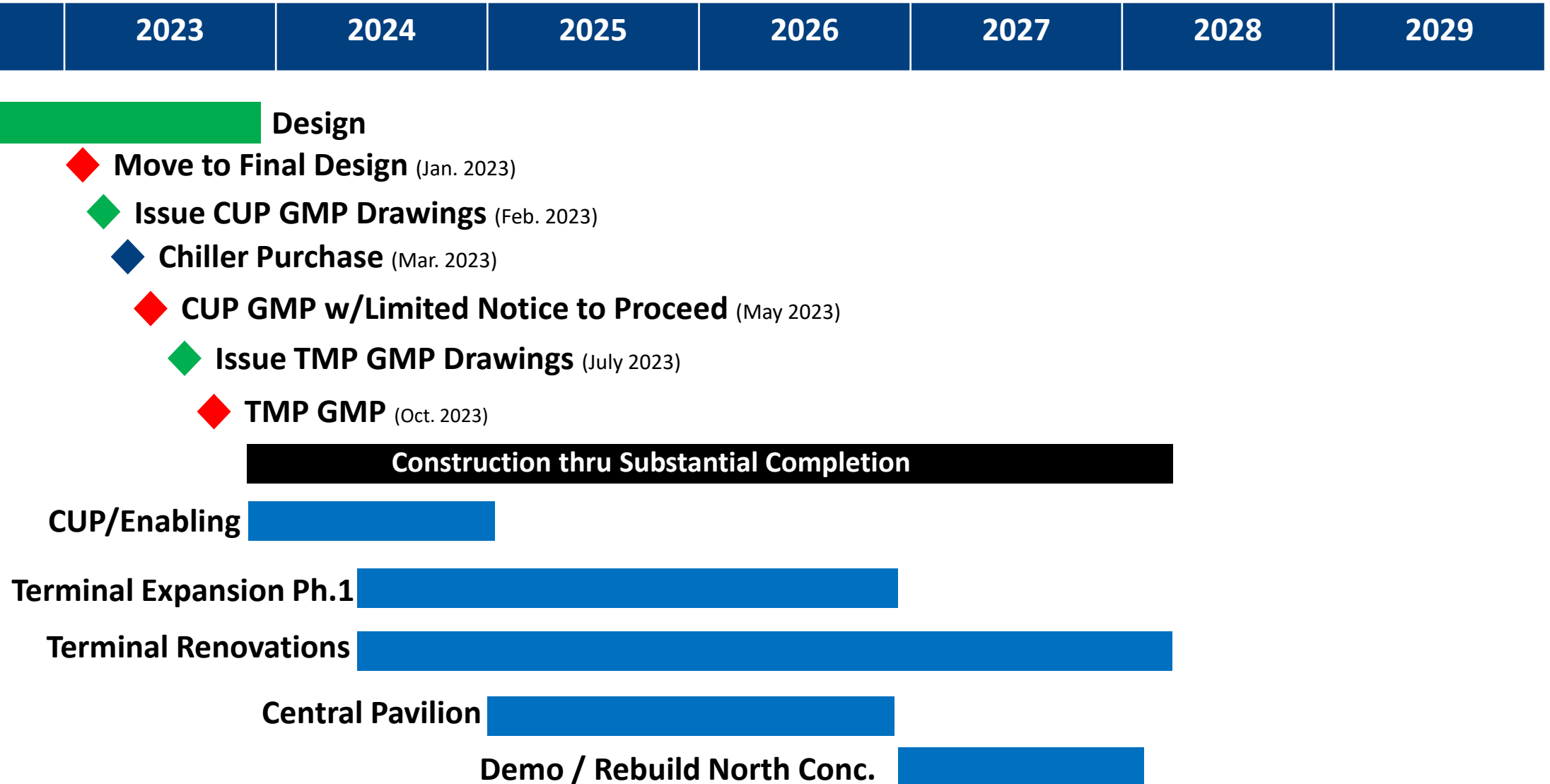

Trade Opportunities

Scopes of Work

Demolition
Earthwork / Site Utilities
Auger Cast Piles
Micro piles
Turnkey Concrete
Miscellaneous Steel
Exterior Masonry
Ornamental Metals
Rough Carpentry
Architectural Woodwork
Airport Millwork
Doors / Frames / Hardware
Curtainwall / Metal Panels
Drywall and Ceilings
Painting
Waterproofing/Caulking
Apron Paving

Roofing
Ceramic Tile
Carpet / Resilient Flooring
Overhead Doors
Overhead Cranes
Specialties
Hold Room Seating
Loose Furniture
Conveying Systems
Fire Protection
Mechanical Systems
Electrical Systems
Special Systems
Passenger Boarding Bridges
Metal Panels
Spray Fireproofing
Fencing

Baggage Handling Systems
Cleaning
Dumpsters
Temporary Labor
Temporary Security
Office Supplies

Trade Opportunities

Drawing Release Dates

- **March 1, 2023 – Central Utility Plant and Enabling Work**
 - 80% Construction Document's released for CGMP Development

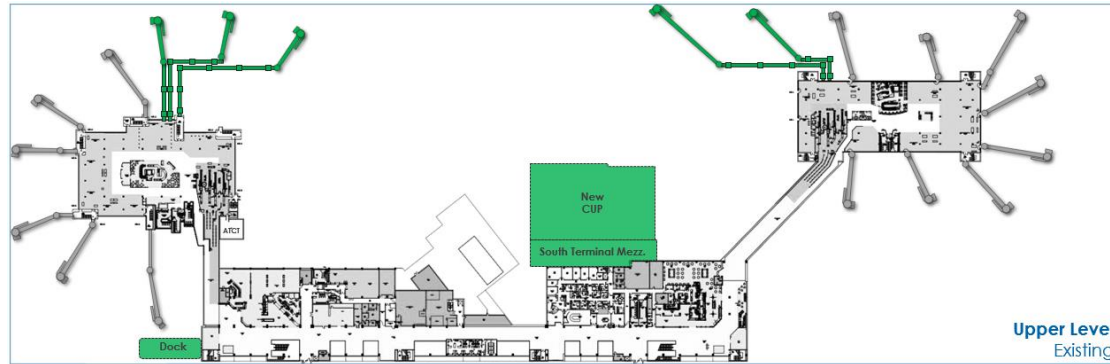

- **July 24, 2023 – Terminal Modernization Program**
 - 80% Construction Document's released for GMP Development

Procurement Process

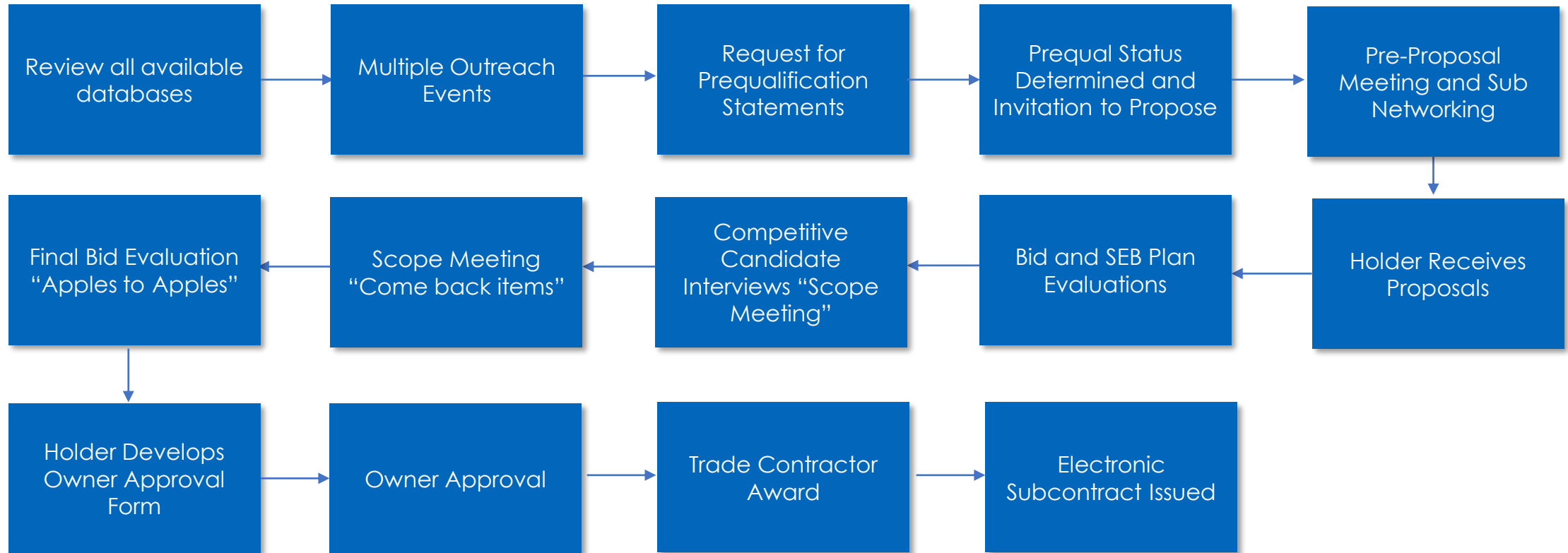

Note:

Procurement plan subject to revisions (Federal funding)

Procurement Process

- **Basis of Proposal Evaluation**

- Pricing
- Completion of Exhibit One "Scope Checklist"
- Plan to Execute the Work
- SEB/DBE Participation Plan
- Project Team
- Proposed Schedule
- Unit Prices



Procurement Process

- **Meet or Exceed the SEB/DBE Goal**
 - 24/7 Project Website for Updates (www.holder-oma.com)
 - Numerous Outreach Opportunities
 - “Right sizing” packages for prime opportunities
 - Encourage networking, mentor/protégé and sub-tier opportunities
 - Trade Contractors required to submit preliminary and final SEB/DBE Plans



Procurement Process

- **Certifying Entities**

- City of Omaha SEB Program
- Nebraska DOT Program (DBE)

- **SEB/DBE Process**

- Holder will indicate goals by Trade in Exhibit One
- Proposing Trade Contractors should strive to meet these goals at a minimum and provide good-faith back-up as to attempts and efforts to engage SEB/DBE firms.
- Proposing Trade Contractors should provide the “preliminary SEB/DBE Plan” with the proposal
- Participation considered in Award

Project Participation Requirements

Pre-Qualify

- Type of Firm
- Number of Employees
- Experience Modification Rate (EMR)
- Self-Performed & Subcontracted Scopes of Work
- Licenses
- SEB/DBE Certification
- Annual Billing
- Project Experience
- Bonding/Insurances

Build Relationships

- Develop a rapport
- Build trust
- Communicate the competitive advantages your company offers



Contact Us!



Fireproofing, Masonry, Arch. Precast, Roofing, Waterproofing, Interior Glass

Blessing Awobayiku

Trade Responsible Engineer
bawobayiku@holder.com



Millwork, Doors/Frames/Hardware, Carpet/Flooring/Tile, Painting

Faiz Olajide

Trade Responsible Engineer
folajide@holder.com



Site Fencing, OH Doors/Equipment, Specialties, Signage, Furnishings

Will Tuten

Trade Responsible Engineer
wtuten@holder.com



General Project Information

Tim Wilson

Preconstruction Director
twilson@holder.com



Fire Protection, Mechanical, Electrical, Special Systems, PBB's, Temporary Fixed Lengths

Brandon Owen

Trade Responsible Engineer
bowen@holder.com



Demolition, Earthwork/Site Utilities, Paving, Deep Foundations, Concrete, Steel, Drywall & Ceilings

Tyler Chism

Trade Responsible Engineer
tchism@holder.com



General Preconstruction Information

Naomi Kartz

Preconstruction Manager
nkartz@holder.com

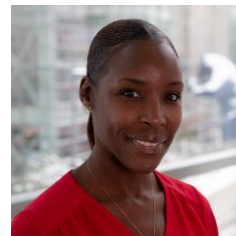

SEB/DBE Participation

Erica Lige

Diversity, Equity, & Inclusion Manager
elige@holder.com



THANK YOU

